

# I-Series

Electric fireplace

## WARM UP YOUR HOME!

The I-Series introduces a built-in electric Heatflow System. Set the heating level and enjoy efficient warm ambience without any exhaust.



## HEAT FLOW

The I-Series heat flow comes from the front.

## NATURAL LOOK

Resin logs and vivid crystals bring the most spectacular look to the fire.



I-Series 110



I-Series 130



I-Series 220



No chimney



**Disconnect Switch needed**



No smoke or ash



3 available lengths

# I-Series

## Electric fireplace

<b>Power Supply</b>	220 V
<b>heating power</b>	1100 W
<b>Flue</b>	not required
<b>Finish</b>	black powder coated steel
<b>Materials</b>	steel, glass
<b>Application</b>	For indoor and roofed outdoor usage

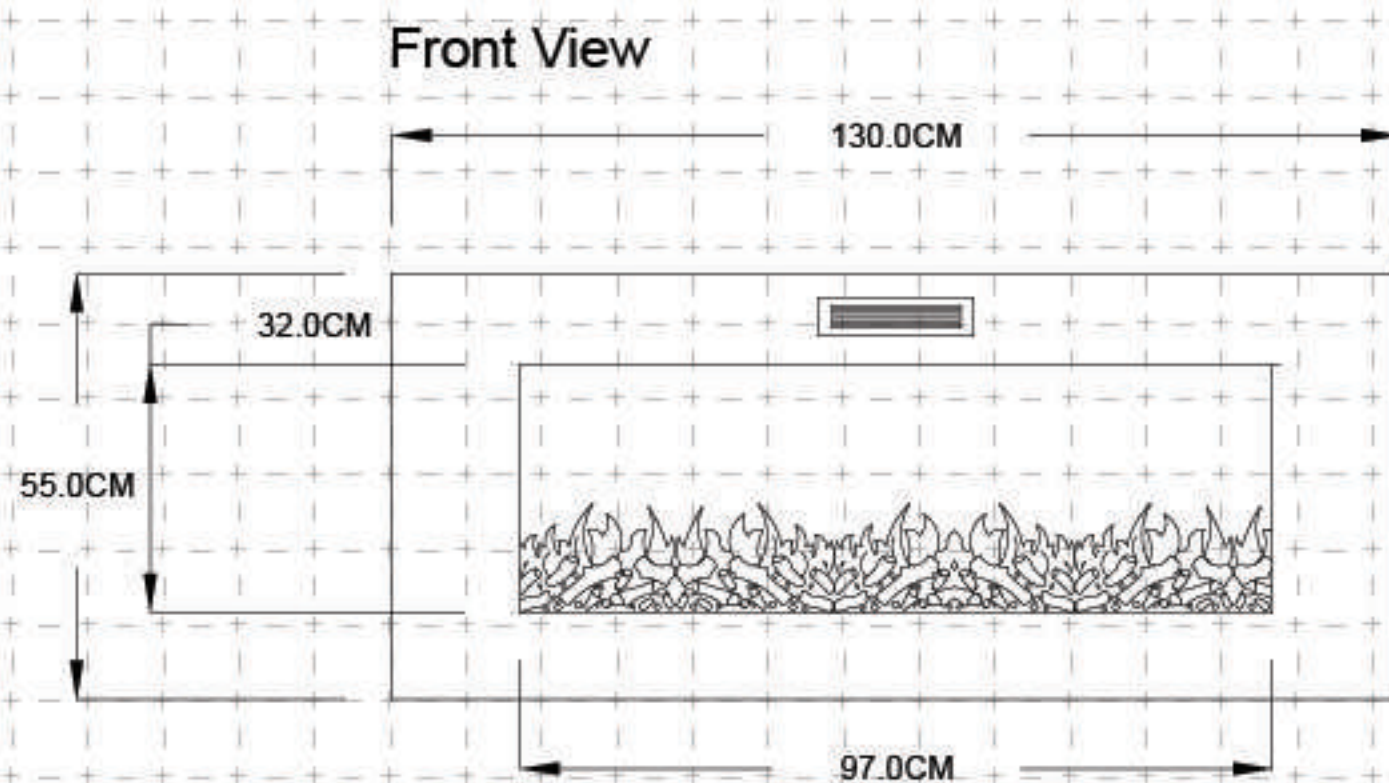
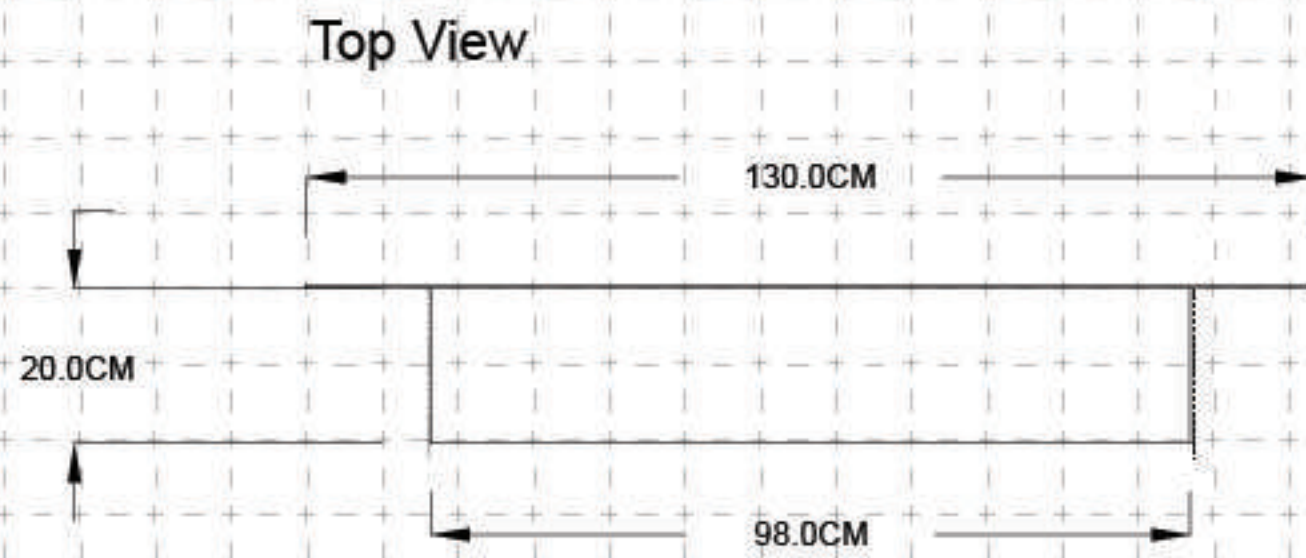

**Side View**

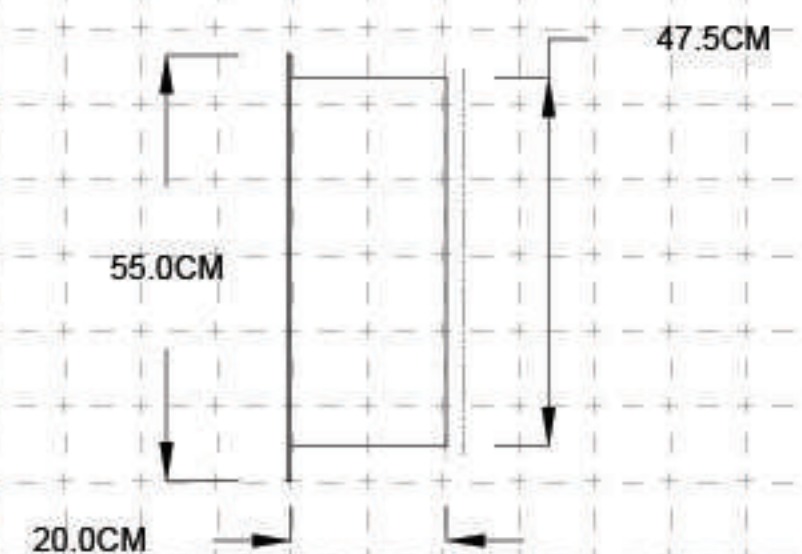

	Dimensions	Viewing area	Opening Size	Weight
I-Series 220	220x60x20 cm	190.5x32 cm	192.5x50x22+ cm	22 kg
I-Series 130	130x55x20 cm	97x32 cm	99x50x22+ cm	16 kg
I-Series 110	110x55x20 cm	78x32 cm	80x50x22+ cm	12 kg